

**Please, read this manual
carefully before use!**

Owner's Manual



Cordless multifunctional garden trimmer

KS MFT-20V

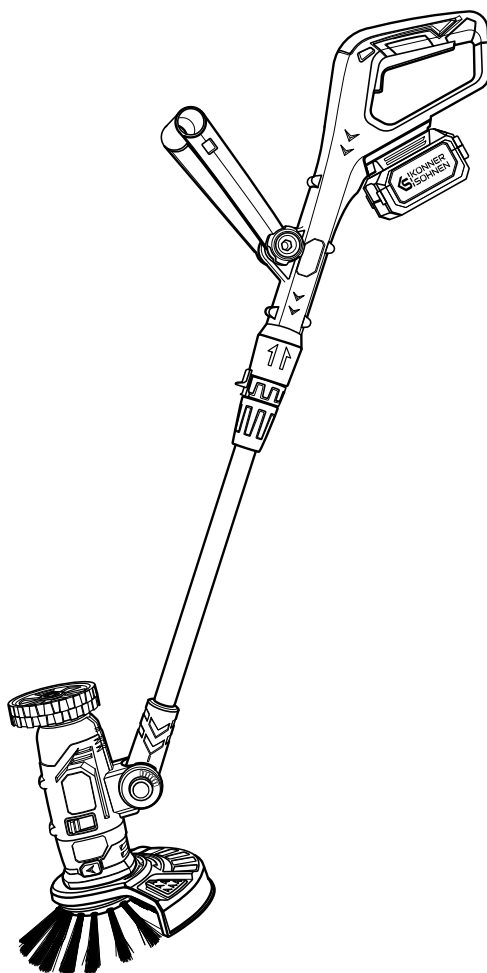



Thank you for choosing **Könnér & Söhnen®** products. This manual contains a brief description of safety, setup and use. More information can be found on the official importer's website in the support section: **konner-sohnen.com/manuals**

You can also go to the support section and download the manual by scanning the QR code or on the website of the official importer of **Könnér & Söhnen®** at **www.konner-sohnen.com**



*Please, read this manual
carefully before use!*

The manufacturer of **Könnér & Söhnen®** products reserves the right to make changes that may not be reflected in this manual, namely:

- The manufacturer reserves the right to make changes in the product design, configuration and construction.
- The images and drawings in this manual are for reference only and may differ from the actual components and inscriptions on the products.

Contact information that you are free to use in case of any problems can be found at the end of this manual. All information in this manual is correct to the best of our knowledge and belief at the date of its publication. The current list of service centers can be found on the official importer's website at **www.konner-sohnen.com**



ATTENTION – DANGER!



Failure to follow the recommendations marked with this sign may lead to serious injury or death of the operator or third parties.



IMPORTANT!



Useful information while operating the machine.

IMPORTANT SAFETY INFORMATION

1

WORK AREA

- Keep the work area clean and well lit. Clutter or darkness in the work area can lead to accidents.
- Do not operate power tools in explosive atmospheres, such as in the presence of flammable liquids, gases or dust. Power tools create sparks, which may ignite the dust or fumes.
- Keep children or unauthorized individuals away from the work area, while working with power tools. Distractions can lead to loss of control over the tool.

ELECTRICAL SAFETY

- Do not store or use power tools in wet conditions (rain, snow). Water entering a power tool will increase the risk of electric shock.

PERSONAL SAFETY

- Do not operate tool when you are tired or under the influence of drugs, alcohol or medication.
- Use safety equipment. Always wear eye protection. Safety equipment such as dust mask, non-skid safety shoes, hard hat, or hearing protection will reduce personal injuries.
- Do not overreach. Always keep proper footing and balance. This enables better control of the power tool in unexpected situations.
- Do not wear loose clothing or jewellery, keep your hair, clothing and gloves away from moving parts. Loose clothes, jewellery or long hair can be caught in moving parts.

POWER TOOL USE AND CARE

- Store idle power tools out of the reach of children.
- Keep the power tool in good working condition.

ADDITIONAL SAFETY WARNINGS FOR TRIMMERS

2

- Avoid Unintentional Starting. Do not carry battery-installed equipment with finger on switch. Be sure switch is off when installing a battery cartridge.
- In case of any issues with the trimmer or improper operation, immediately turn off the electric motor.
- Switch off and remove the battery cartridge when resting and when leaving the equipment unattended, and place it in a safe location to prevent danger to others or damage to the equipment.
- Don't force the equipment. It will do the job better and with a lower risk of injury when it's used at the speed it was designed for.
- Don't overreach. Always keep proper footing and balance.

CHECK BEFORE STARTING

- Always remove the battery to prevent the machine being started by accident. Always disconnect the battery before any maintenance on the machine.
- Before using the machine and after any impact, check for signs of wear or damage and repair as necessary.
- Carefully inspect the area where you plan to use the trimmer. Clear it of any scattered objects, stones, glass, nails, wires, ropes, etc., that could get caught on the disc blade or protective cover and cause damage.

PERSONAL SAFETY

- The cutting tool does not stop immediately after the machine is turned off.
- Store the equipment in a lockable area so that it is out of reach of children and unauthorized persons.
- Keep hands and feet away from the cutting tool, especially when the motor is running.

POWER TOOL USE AND CARE

- Only use original spare parts.
- Always ensure that ventilation openings are kept clear of debris.
- All covers, guards and handles must be fitted before starting.
- Only use the machine in daylight or in other well-lit conditions.
- Never use the machine in bad weather, for instance in fog, in rain, damp or in wet locations, strong winds, intense cold, risk of lightning, etc. Extremely hot weather may cause overheating of the machine

OPERATING INSTRUCTIONS

3









- Work only during daylight or under sufficient artificial lighting!
- Do not use the device in rain or wet conditions!
- Do not force the power tool. Use the correct power tool for your application. A properly selected tool works more efficiently and safely within the limits it was designed for.
- Do not use the power tool if the switch does not turn it on and off. Any power tool that cannot be controlled with the switch is dangerous and must be repaired.
- Disconnect the plug from the power source and/or remove the battery pack, if detachable, from the power tool before making any adjustments, changing accessories, or storing power tools. Such preventive safety measures reduce the risk of starting the power tool accidentally.
- Store idle power tools out of the reach of children and do not allow persons unfamiliar with the power tool or these instructions to operate the power tool. Power tools are dangerous in the hands of untrained users.
- Maintain the tools and accessories. Check for misalignment or jamming of moving parts, damaged components, or other defects that may affect the tool's performance. If damaged, repair the tool before use. Many accidents occur due to poorly maintained tools.
- Use the tool, accessories, and attachments in accordance with these instructions, taking into account the working conditions and the nature of the task being performed.

- Keep handles and grasping surfaces dry, clean and free from oil and grease. Slippery handles and grasping surfaces make it difficult to control the tool safely in emergency situations.
- Do not operate the product in a place where objects can get stuck and be thrown out by the product. Ejected objects can cause serious personal injury and/or material damage.
- Stop the product and make sure that all moving parts have stopped before you put the product down.
- Do not attempt to stop the product with your hands.
- Always hold the product by the designated handles.
- Use the product only during daylight.
- Always keep balance while working.
- Do not run with the product.
- Make sure that the ventilation openings are free from debris.
- Never lay the power tool down until the accessory has come to a complete stop. The spinning accessory can catch on the surface and pull the power tool out of your control
- Don't work with the tool while holding it close to your body. Accidental contact with the spinning accessory could snag your clothing, pulling the accessory into your body.
- Remember that wire bristles can fly off the brush even during normal operation. Do not overload the wires by applying excessive pressure on the brush. Wire bristles can easily penetrate light clothing or skin.

SYMBOLS

4

Some of the following symbols may be used on this product. Please study them and learn their meaning. Proper interpretation of these symbols will allow you to operate the product better and safer.

	Read all safety warnings and all instructions. Failure to follow the warnings and instructions may result in electric shock, fire and/or serious injury.
	This power tool complies with applicable European directives.
	Wear personal protective equipment. Basically, wear protective goggles or, even better, face protection, ear protection, safety helmet, cut-protection working clothes, cut-protection safety boots with anti-slip soles.
	Beware of falling objects. Keep bystanders away.
	Keep the equipment away from nearby people. Keep bystanders away.
	Do not use the machine in the rain or leave it outdoors when it is raining.
	Guarantee sound power level.
	Electrical appliances must not be disposed of with the domestic waste.

1. Motor housing
2. Locking switch
3. Wheel
4. Slider swivel head release
5. Rotary handle with quick release clip
6. Safety switch
7. Rubber anti-slip handle
8. ON/OFF switch
9. Lithium battery (battery and charger are not included in the package).
10. Height-adjust collar
11. Telescopic tube
12. Angle adjustment rod lock
13. Lock button
14. Weed brush
15. Interchangeable head for plastic blades
16. Interchangeable head for nylon thread
17. Grass trimmer head unit
18. Plastic blades
19. Joint cleaner head unit
20. 110 mm Metal disc brush
21. Hex key (3 mm, 4 mm)
22. 110 mm Plastic disc brush

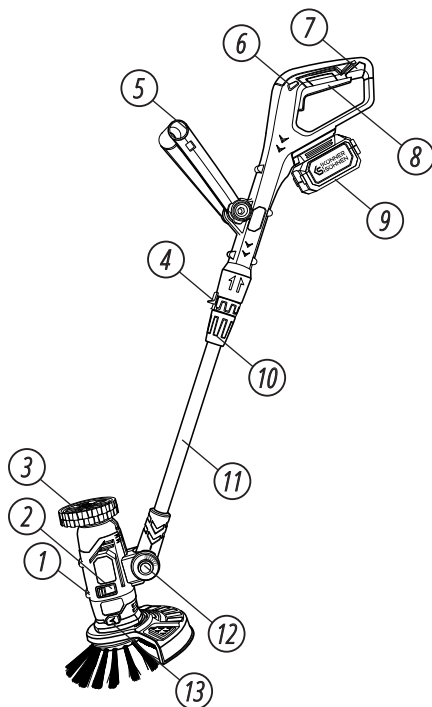

PACKAGE CONTENT LIST

- 1 × 20V Cordless trimmer base unit
- 1 × Weed brush head unit
- 1 × Grass trimmer head unit
- 1 × Joint cleaner head unit
- 1 × 10 Plastic blades with blade holder
- 1 × Housing for spools and plastic blades (for use with trimmer)
- 1 × 110 mm Alternate metal disc brush
- 1 × Hex Key 3 mm
- 1 × Hex Key 4 mm

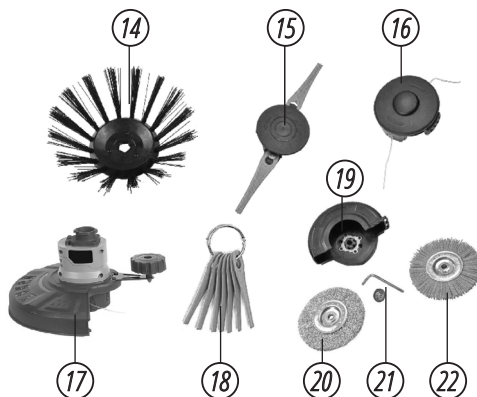

IMPORTANT!



Manufacturer reserves the right to make changes and/or improvements in design, components set and technical attributes without notice and without incurring obligation. The pictures in this manual are schematical and may not match the parameters of original product.

Model	KS MFT-20V
Rated voltage	DC 20V
Possible battery capacity	2,0 – 4,0 Ah
Battery and charger	not included
Max cutting width (nylon thread)	250 mm
Max cutting width (cutting disc)	220 mm
Line length	2 × 2 m
Line diameter	1,6 mm
No load grass grimmer speed	8000 rpm
No load weed cleaner speed	2400 rpm
No load joint cleaner speed	2400 rpm
Noise level (Lwa)	96 dB
Gross dimensions (L×W×H)	976×280×222 mm
Net weight	3,8 kg

OPERATION

7

STARTING AND STOPPING THE GARDEN TOOL (Fig. 1)

Before switching on or using the garden tool, make sure that all components are securely connected, no accessory tools (Hex Keys) are on the device, the telescopic handle is fixed, and the battery is charged.

- To turn on the garden trimmer, insert the battery into the battery slot. Press the safety switch and press the ON/OFF switch upward towards the handle. As long as you keep the ON/OFF switch pressed, the device will run.

- The safety switch only needs to be pressed to turn on and can be released afterward. To turn off the garden tool, simply release the ON/OFF switch.

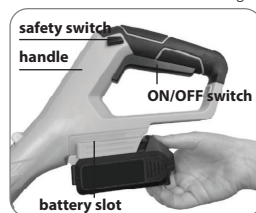

Fig. 1

ADJUSTMENT OPTIONS

Height adjustment of the telescopic tube (fig. 3). To customize the telescopic tube to your required height, rotate the lock clockwise. Pull out the telescopic tube and secure it by turning the lock counter-clockwise again. By moving the slider forward and simultaneously turning the handle, it can be rotated by 90°. This function is especially useful during trimming.

Adjustment of the second handle (fig. 2). The 2nd handle can be adjusted up or down by up to 180 according to individual preference. To do this, loosen the screw on the side of the handle, slide the handle up or down to the desired position, and secure it by tightening the screw again.

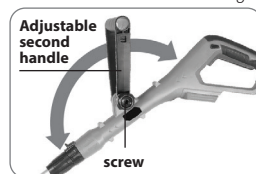
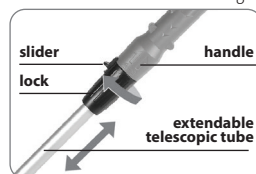

Fig. 3



WARNING!



Make sure the teeth at the lower end of the handle are fully engaged before tightening the screw again.

JOINT CLEANER

The trimmer will arrive with the Plastic disc brush (fig. 4) unit already connected. You have a choice between a metal cleaning disc and nylon cleaning disc to use depending on the required task and work surface. Use this cleaning head for the joints between block paving, slabs, Indian stone and other exterior flooring.

This brush can also be used to clean the front surface of external coatings, but we recommend testing a small area first to ensure that the surface is not damaged or marked.

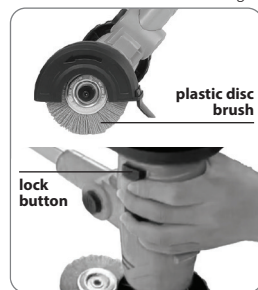

Fig. 4

TO CHANGE DISC BRUSHES



WARNING!



Ensure that the device is switched off, and the battery has been removed before and during the following steps!

Press and hold the lock button (fig. 4) located on side of the Joint cleaner head unit

Then insert the correctly sized Hex key into the locking nut and rotate clockwise to loosen. Remove bolt and washer followed by the cleaning disc.

To finish, Insert alternative cleaning disc, replace the bolt and washer and rotate anti-clockwise with the Hex Key to tighten until secure.

CHANGING OF THE HEAD UNITS



WARNING!



Ensure that the battery is removed before changing the head units!

To release the current head unit, simply push the lock button (fig. 5) all the way to the left, then all the way back to the right. Ensure that the head unit is supported so it does not fall and become damaged.

To install a new head unit simply align the head unit with the main body (So that the locking switch and lock button are on the same side of the unit) and push until it clicks securely into place.

Fig. 5



Fig. 6

WEED CLEANER

Use this cleaning head to remove weeds, moss and debris from around the garden and exterior flooring.

REPLACING THE CLEANING BRUSH



ATTENTION – DANGER!



Ensure that the battery is removed before replacing the cleaning brush!



Press and hold the lock button (fig. 6) located on side of the weed cleaner head unit

Then insert the correctly sized Hex key into the locking nut and rotate clockwise to loosen. Remove bolt and washer followed by the cleaning brush.

To finish, Insert replacement cleaning brush, replace the bolt and washer and rotate anti-clockwise with the Hex Key to tighten until secure.

Re-insert your battery and the tool is now ready for use!

GRASS TRIMMER

Use this Grass Trimmer Head to effortlessly tackle lawn edging, control those unwanted weeds and to carry out precision trimming. The flower protection bar will protect valuable plants while the grass trimmer is in use.

The trimmer can be operated in 2 modes:

1. Grass Trimming Mode: For the best results, keep the trimmer head parallel to the ground and slightly above it. If necessary the head unit can be adjusted to the desired angle. Press and hold the angle adjustment button (Fig. 7), set the desired angle, and release the button. Note that the arrow should always point to one of the position markers, and the adjustment button should click into place clearly.

2. Lawn Edging Mode: To use the tool as a lawn edge trimmer, slide the head rotation lock (Fig. 7) forward and simultaneously turn the handle to rotate it 90°.

Fig. 7



Standard function

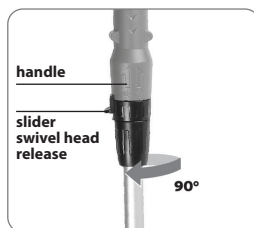

Lawn edge function

HOW TO REPLACE THE NYLON SPOOL (Fig. 8)



ATTENTION – DANGER!



For your own safety, remove battery before adjusting the nylon thread!

To replace the spool with nylon thread or use the interchangeable head with plastic blades, follow these steps:

1. On the spool cover, there are two marked points opposite each other. Press both points simultaneously and pull the spool cover from the securely mounted spool holder, as illustrated below.
2. Remove the spool.
3. Before attaching the new spool along with the spool cover to the lawn trimmer, make sure that the spring is correctly inserted into the spring slot. The slightly wider end of the spring should fit into the slot, located on the spool holder.
4. Now, insert the new spool along with the spool cover with the "marked points" into the recesses of the spool holder. Once you have fitted them together appropriately and the spool cover is snapped into place, you can start your work.

Fig. 8

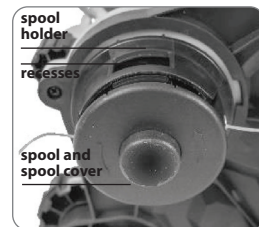
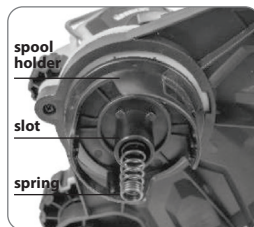
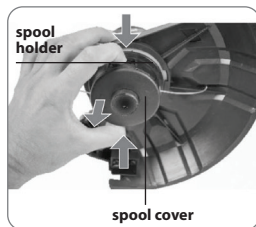

ADJUSTING THE NYLON THREAD (Fig. 9)



IMPORTANT!



This process is very important and must be repeated at regular intervals!



ATTENTION – DANGER!



For your own safety, remove battery before adjusting the nylon thread!

The nylon thread will wear down during operation, the length of the thread will need to be checked regularly. You can adjust the thread length either manually or automatically!

Manual: Press the spool button with one hand and pull each thread end to the desired length one after the other. Release the button when you have finished adjusting the thread length. If the thread length becomes slightly too long, it will be automatically trimmed to the appropriate length when the device is started, using the blade located near the guide wheel.

Automatic: While operating your device, you can automatically extend the thread length at any time by briefly pressing the running device against the ground with the spool button. Pressing against the ground and the running motor will automatically unwind the thread from the spools.

Fig. 9

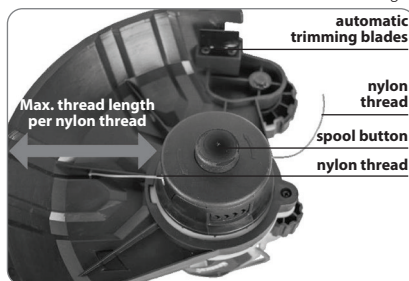

WARNING!



If you press the lawn trimmer against the ground for too long, the spool will quickly run out of thread!

REPLACING NYLON THREAD WITH PLASTIC BLADES



ATTENTION – DANGER!



For your own safety, remove battery before changing spools.

1. Remove the spool along with the spool cover.
2. Take the interchangeable head for the plastic blades with two pre-attached plastic blades.
3. Double-check that both plastic blades are securely in place.
4. Ensure that the spring is still correctly positioned in its slot! If the spring is not inserted or has shifted, reinsert it!
5. Then, insert the interchangeable head with the “marked points” into the recesses (see arrow's) of the spool holder. Once you have fitted them together appropriately and the interchangeable head is snapped into place, you can start your work.

Fig. 10

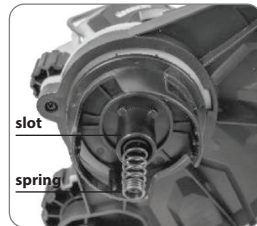
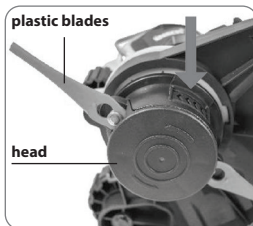
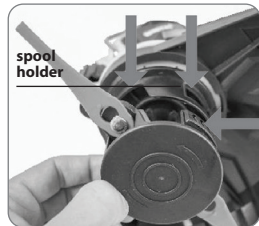

Replacing the plastic blades (Fig. 10) on the interchangeable spool head can be done easily as follows. There is no need to remove the interchangeable spool head for this. However, always ensure that the battery is removed before replacing the blades!

This will first release the plastic blade from the interchangeable head. Then pull the insert upward (away from the interchangeable head) to remove.

To attach a new plastic blade to the interchangeable head, simply place it (as shown in the illustrations below) on the “rivet” and the larger recess and pull it “away” from the interchangeable head to lock into place.

Replacing plastic blade (Fig. 11) on the interchangeable head can be done easily as follows.

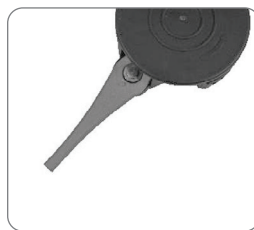
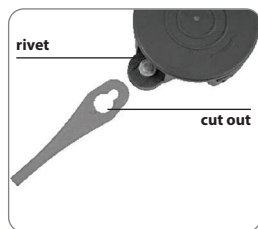

To put on



To pull away

CLEANING AND MAINTENANCE

8

- Regularly clean the ventilation slot in your tool using a soft brush or dry cloth.
- Regularly clean the cutting line and spool using a soft brush or dry cloth.
- Regularly use a blunt scraper to remove grass and dirt from the underneath of the guard.

WARRANTY SERVICE TERMS

9

The international manufacturer warranty is 1 year. Limited warranty starts from the date of retail purchase by the end-user. Make sure to keep your receipt during the whole warranty period. This product is not intended for commercial use. The warranty doesn't cover: chargers for Lithium batteries, bulbs, fuses, accessories as well as normal wear and other exclusions listed below (which applicable for this group of products). This product is not intended for commercial use.

All parts replaced under warranty become the property of Könnér & Söhnen or it's official representative. All parts replaced under warranty will be considered as part of the original product, the warranty on those parts will expire coincident with the original product warranty.

The warranty period begins when the product is delivered to the purchaser. This warranty is non-transferable, it's valid to the original purchaser only. Könnér & Söhnen may choose to repair, replace or refund the power equipment at its sole discretion.

WARRANTY EXCLUSION

- The user has failed to comply with the instructions in this manual.
- The product has damaged or missing identification stickers or labels, serial numbers, etc.
- Product malfunction was due to improper transportation, storage and maintenance.
- In case of mechanical damage (cracks, chips, impact or fall marks, deformation of the housing, power cord, plug, or any other components), if foreign objects are found inside the unit.
- Proper operation of the product can be restored by cleaning off dust and dirt, making necessary adjustments, and performing maintenance.
- Faults were caused by product overload.
- If electrical cables or plugs show signs of mechanical or thermal damage.
- In case of foreign liquids and objects, metal chips, etc. inside the product are found.
- The damage caused by natural factors such as dirt, dust, humidity, high or low temperature, failures due to acts of God or natural disasters, which are beyond manufacturer's control (such as earthquake, tornado, fire, war, etc.).
- Normal wear parts and accessories (fuses, bulbs, keys, buttons, plastic and rubber parts, chargers for Lithium batteries, filters and consumables, etc., as well as normal wear)
- Preventive maintenance (cleaning, washing), installation and adjustment.
- The product was modified or altered.
- In case of malfunctions resulting from normal wear and tear as a result of long-term use (end of life), cosmetic defects.
- Product operation was not stopped and continued after detecting a malfunction.



EC Declaration of Conformity

Nr. 219

The following products have been tested by us with the listed standards and found in compliance with the European Community Machinery Directive 2006/42/EC, Electromagnetic compatibility Directive (EMC) 2014/30/EC, Noise Directive 2000/14/EC.

Manufacturer: DIMAX INTERNATIONAL GmbH
Address: Flinger Broich 203, 40235 Duesseldorf, Germany
Product: Cordless multifunctional garden trimmer "Könnner & Söhnen"
Type / Model: KS MFT-20V

The statement is based on a single evaluation of above mentioned products. It does not imply an assessment of the whole production and does not permit the use of the test lab. logo. The manufacturer should ensure that all product in series production are in conformity with the product sample detailed in this report. The applicant should hold the whole technical report at disposal of the competent all the right.

Applied EC Directives: 2006/42/EC Machinery Directive
2014/30/EC Electromagnetic compatibility Directive
2000/14/EC Noise Directive

Applied Standards: EN 62841-1:2015+A11:2022
EN ISO 12100:2010
EN 60335-1:2012+A11+A13+A1+A14+A2+A15
EN 50636-2-91:2014, EN IEC 55014-1:2021
EN IEC 55014-2:2021, EN ISO 3744: 1995
ISO 11094: 1991

2000/14/EC_2005/88/EC Annex VI

For model KS MFT-20V Noise measured Lwa = 93 dB (A), guaranteed Lwa = 96 dB (A)



Issued Date: 2025-01-20
Place of issue: Duesseldorf
Director: Fomin P.

DIMAX
International GmbH
Flinger Broich 203 40235 Düsseldorf
USt-ID DE296177274
koenner-soehnen.com

P. Fomin

We DIMAX INTERNATIONAL GmbH hereby declare that specified above conforms covering European Parliament and Council Directives, 2006/42/EC of 17 May 2006 Machinery Directive, Electromagnetic compatibility Directive (EMC) 2014/30/EC of 26 February 2014, Noise Directive 2000/14/EC of 8 May 2000. The CE mark above can be used under the responsibility of manufacturer. After completion of an EC declaration of Conformity and compliance with all relevant EC directives.

CONTACTS

Deutschland:

Hergestellt unter Lizenz und Kontrolle der DIMAX International GmbH.

Importeur und Vertreter in Deutschland:
DIMAX International GmbH Flinger Broich 203, 40235
Düsseldorf, Deutschland. Produziert in VRC.

innovationtrade8@gmail.com

www.konner-sohnen.com

European Union:

Manufactured under license and control of DIMAX
International GmbH, Flinger Broich 203, 40235
Duesseldorf, Germany.

Importer and representative in Netherlands DIMAX
International Poland Ltd, Południowa 8 st, 05-0830
Stara Wieś, Poland. Assembled in PRC.

innovationtrade8@gmail.com

www.konner-sohnen.com

The United Kingdom:

Innovation Trade Ltd., 63/66 Hatton Garden Fifth Floor,
Suite 23, London, EC1N 8LE, info.uk@dimaxgroup.de

Technical support

support.uk@dimaxgroup.de

konner-sohnen.com.uk

France:

Fabriqu  sous licence et contr le de DIMAX
International GmbH, Flinger Broich 203, 40235
D sseldorf, Allemagne.

Importateur et repr sentant en France et en Belgique
DIMAX International Poland Ltd, Po udniowa 8 st,
05-0830 Stara Wie , Pologne. Assembl  en RPC.

innovationtrade8@gmail.com

www.konner-sohnen.fr

Esp  a:

Fabricado bajo licencia y control de DIMAX
International GmbH, Flinger Broich 203, 40235
D sseldorf, Alemania.

Importador y representante en Espa  a de DIMAX
International Poland Ltd, Po udniowa 8 st,
05-0830 Stara Wie , Polonia.

Ensamblado en la Rep blica Popular China.

innovationtrade8@gmail.com

www.konner-sohnen.es

Polska:

Wyprodukowano na licencji i pod kontrol  DIMAX
International GmbH, Flinger Broich 203,
40235 Duesseldorf, Niemcy.

Importer i przedstawiciel w Polsce:

DIMAX International Poland Sp. z o. o. ul. Po udniowa 8,
05-0830 Stara Wie , Polska. Zmontowany w CRL.

innovationtrade8@gmail.com

www.konner-sohnen.pl

  kr  ina:

Виготовлено за л ценз єю та п д контролем
DIMAX International GmbH, Flinger Broich 203,
40235 Д ссельдорф, Н меччина.

  портер та представник в   кра  ні:

ТОВ "ТЕХНО ТРЕЙД КС" вул. Електротех  чна 47,
02232, м. Ки в,   кра  на. Змонтовано в КНР

www.konner-sohnen.com.ua